

# POINTE HILTON TAPATIO CLIFFS RESORT MOUNTAIN EXPERIENCE

## A Guide to the Hiking and Biking Trails in the Phoenix Mountain Preserve

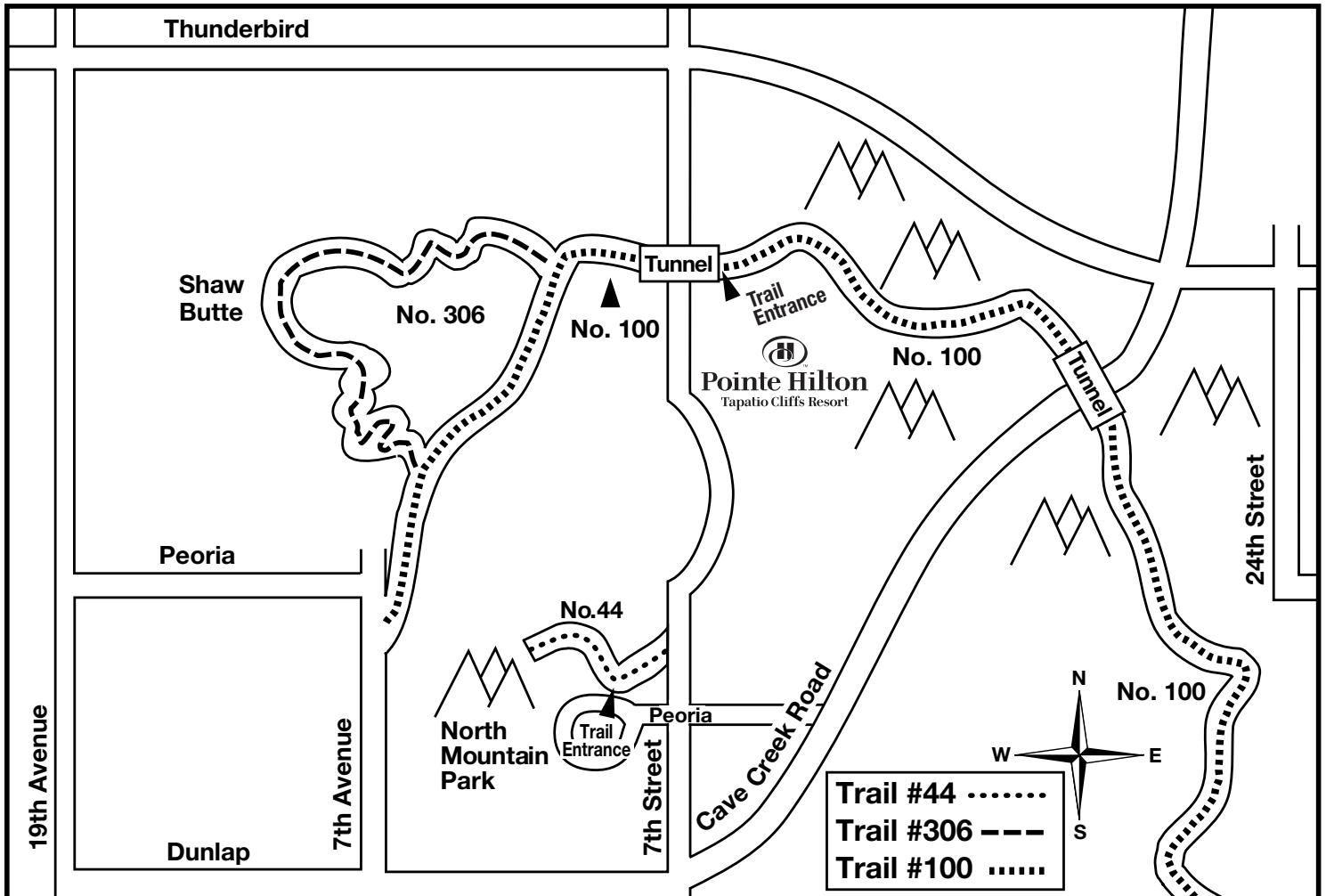

Help preserve our mountain parks by hiking only on the designated trails.

### North Mountain National Trail (No. 44)

This challenging trail traverses 1.6 miles through the Mountain Preserve, with elevations ranging from 1,490 feet to 2,104 feet.

*Rated:* moderate to difficult

**To access Trail 44,** drive one mile south on 7th Street to Peoria. Turn right (west) into North Mountain Park and follow the drive to the trail head.

### Charles M. Christiansen Memorial Trail (No. 100)

This scenic extended trail wanders through the entire Phoenix Mountain Preserve west to east. The entire trail covers 10.7 miles and elevations that range from 1,290 feet to 2,080 feet.

*Rated:* easy to moderate

**The entrance to Trail 100** is located at the north end of the property between the two tennis courts.

### Shaw Butte Trail (No. 306)

Looping around Shaw Butte, a popular launching area for local hang-gliding enthusiasts, this four-mile trail includes elevations of 1,390 feet to 1,890 feet.

*Rated:* moderate to difficult

**Trail 306** can be accessed from Trail 100. The entrance to Trail 100 is located at the north end of the property between the two tennis courts.

**Hiking Tips:** Always carry water (no glass containers) and wear appropriate shoes and clothing for the weather and conditions. Stay on designated trails and do not hike after sunset. Use trails at your own risk.

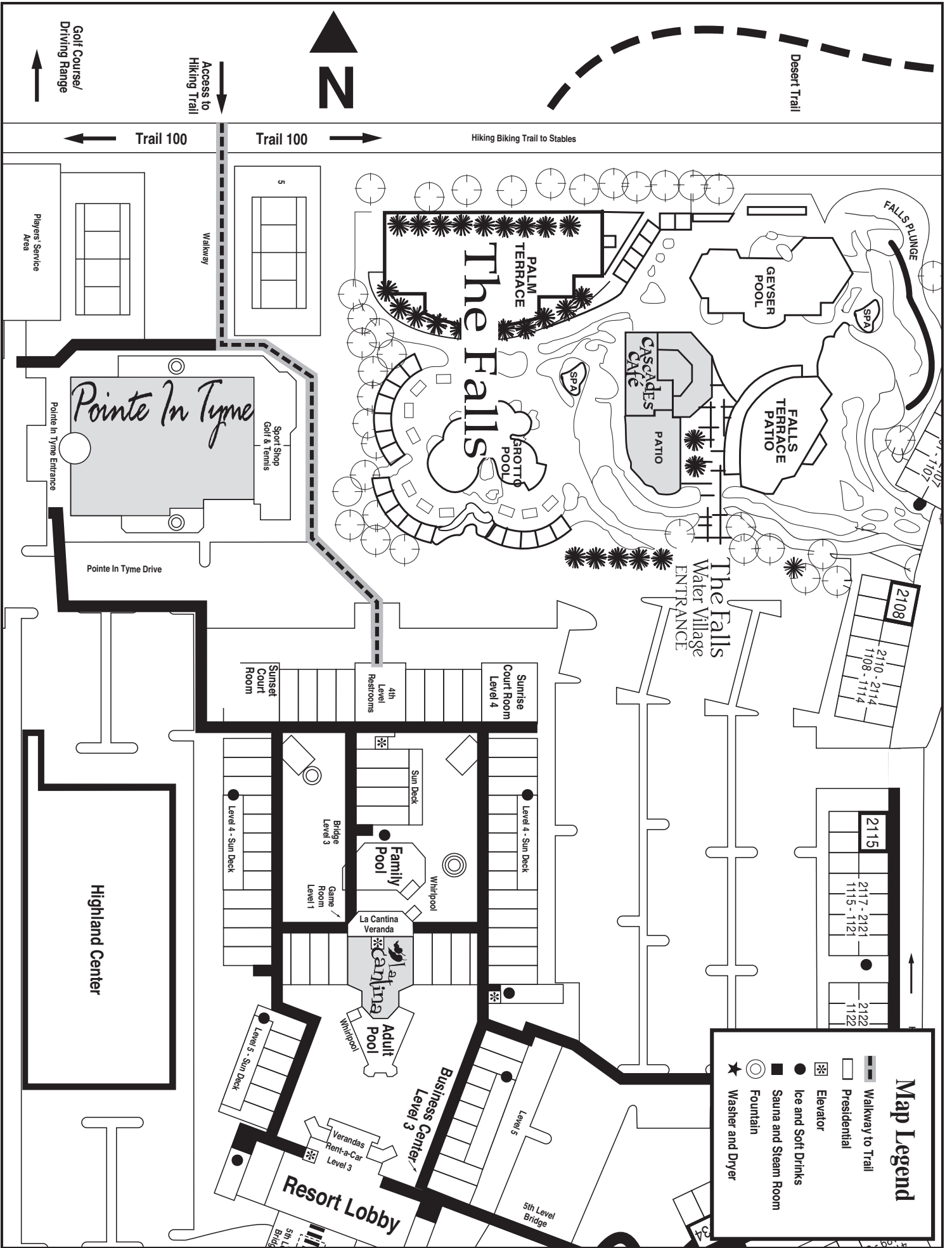

Desert Trail

Hiking Biking Trail to Stables

Trail 100

Trail 100

Golf Course/  
Driving Range

Access to  
Hiking Trail



FALLS PLUNGE

GEYSER POOL

FALLS TERRACE PATIO

CASCADE'S CAFE

PATIO

The Falls

SHROTTO POOL

The Falls  
Water Village  
ENTRANCE

Pointe In Tyme

Sport Shop  
Golf & Tennis

Pointe In Tyme Drive

Sunset  
Court  
Room

Sunrise  
Court Room  
Level 4

4th  
Level  
Restrooms

Level 4 - Sun Deck

Bridge  
Level 3

Family  
Pool

Game  
Room  
Level 1

La Cantina  
Veranda

La Cantina

Adult  
Pool

Level 5 - Sun Deck

Business Center  
Level 3

Resort Lobby

Highland Center

2108  
2110 - 2114  
1108 - 1114

2115  
2117 - 2121  
1115 - 1121  
2122  
1122

### Map Legend

- Walkway to Trail
- Presidential
- Elevator
- Ice and Soft Drinks
- Sauna and Steam Room
- Fountain
- Washer and Dryer